



# sb

[www.iaks.org](http://www.iaks.org)

International magazine for  
sports, leisure and recreational  
facilities

52<sup>nd</sup> year

ISSN (Print): 0036-102X  
ISSN (Internet): ISSN 2198-4271

# 6/2018

## POOLS AND LEISURE FACILITIES

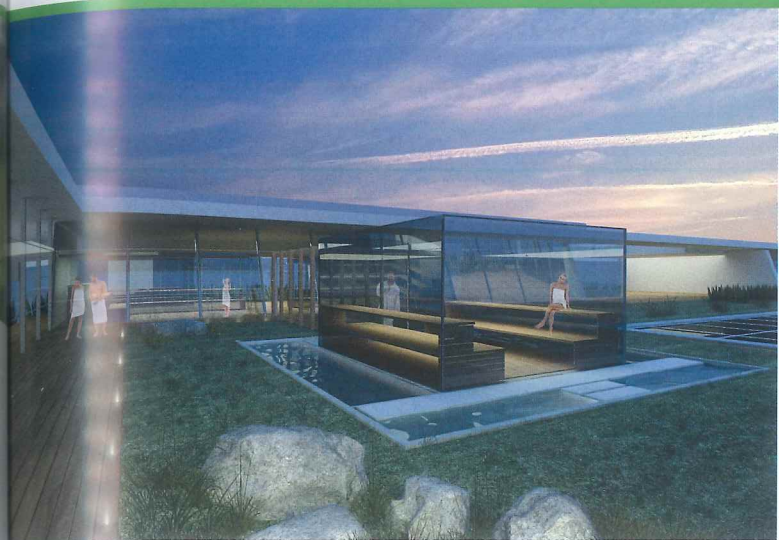

## GLASS VOLUME PLACED ON A GREEN TERRACE

RENOVATION OF THE SPA IN GRADO, ITALY

**Studio Alberto Apostoli is designing the spa of the new Grado thermal baths. The overall design was created in collaboration with Archest (team leader), Dejaco+Partner, Studio Apostoli, Von Lutz, Thermostudio, Deerns, and Geomok.**

The redevelopment of this thermal centre is an important step in the revival of tourism in Grado, a prominent marine spa resort. It boasts a tradition that goes back to the early nineteenth century, later confirmed by the construction of the first marine baths in 1932 and the current spa in 1974.

The design intent is to consolidate the tourist vocation of the municipality of Grado, creating a hub for economic activities, with a view to global promotion of the area. The design of the wellness centre was entrusted to Studio Apostoli.

Users access this area from the main atrium and proceed upstairs initially to the roughly 260 m<sup>2</sup> fitness area, a large equipped space that can accommodate up to 50 guests.

Through a corridor overlooking the green courtyard, one continues towards the beauty area of about 320 m<sup>2</sup>. The area includes a salon dedicated to makeup, hair, manicure and pedicure and eight massage cabins, offering a range of diversified treatments and a menu with foods inspired by local traditions and products.

The roughly 650 m<sup>2</sup> wellness area is contained within a glass volume placed on the green terrace; it can accommodate 60 guests. It is strongly themed according to its division into the four main elements of water, air, fire and earth.

The first area is dedicated to water and the sea and encompasses all wet treatments. On the left, the room offers halotherapy and iodine inhalation, while, further on, users arrive in a circular glass atrium which, on one side, houses the hammam and, on the other, the tepidarium and caldarium. The path of showers decorates and completes the space taking up the theme of water.

The next area is dedicated to the air. It is an open space used for relaxation, equipped with chaises longues and characterised by winding partitions and ceiling veils, which also continue in the adjacent bistro.

The element of fire is the topic of the third area for all dry treatments. A central atrium, dominated by glazed showers, opens onto three different types of saunas (salt sauna, herbal sauna and Finnish sauna). Via a central passage the guest is led to the outdoor terrace. Like an island in the middle of the sea, another large glazed sauna stands like a tower surrounded by cold pools at different temperatures and an "Ashiyu", an invigorating Japanese treatment for the limbs. A long Kneipp path and a large cold pool complete the outdoor area.

[www.albertoapostoli.com](http://www.albertoapostoli.com)